

14" X 42" X 8"

FIRE EXTINGUISHER & VALVE CABINET RECESSED

STANDARD CONSTRUCTION FEATURES

- 1/2" Turnback Adjustable Front
- Full Glass Panel (10" x 38" Glass Size) 9" x 37" Opening
- Grey or White Powder Coat Finish
- Accomodates 20lb Dry Chemical Fire Extinguisher & 1 1/2" or 2 1/2" Valve

OPTIONS

- Break Glass Door & Lock
- Cylinder Lock
- 304 or 316 Stainless Steel Adjustable Front (#4 Satin Finish w/ Invisible SOSS Hinges & 3/4" T.B.)
- Full Metal Front



FRONT

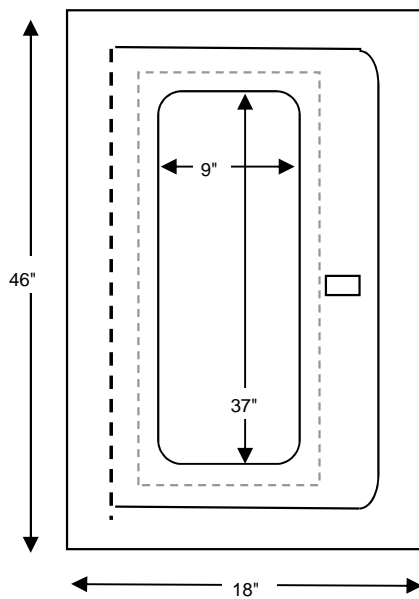

SIDE

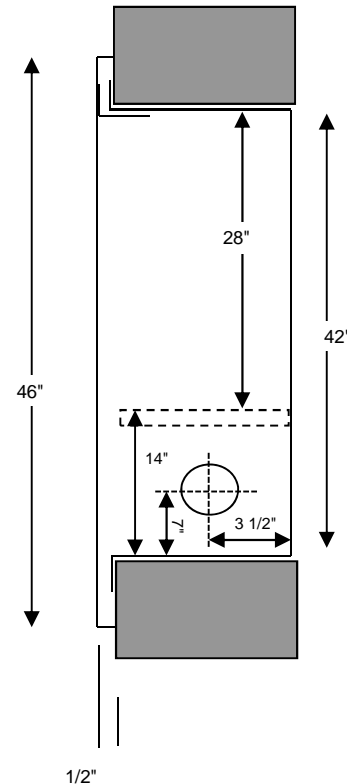

TOP

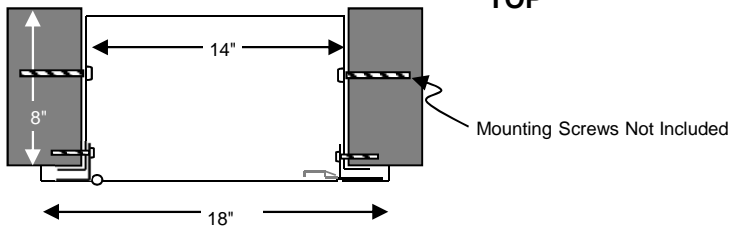

MADE IN CANADA

1455 Rue Pitfield, Saint-Laurent, QC, H4S 1G3
Tel : 514 333 3389 / Fax: 514 333 1887
www.cfhsecurite.com

CFH Sécurité inc.
Prévention incendie